



**MORTON
MIXERS**

Continuous Multi-Mixer



Mixing is our Business



Morton Mixers Ltd are at the forefront in the design, manufacture and applications technology of plough blade mixers, and has gained world wide reputation for reliability and quality.

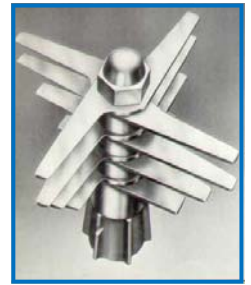

The Multi-mixer is designed to meet the demands for fast precision mixing of components with wide ranging quantity proportions, densities, structures and flow characteristics.

Continuous Mixers consistently give high levels of homogeneity required in today's process Industries.

- Heating/Cooling Jacket
- Insulation and Lagging
- Vacum Construction
- Flameproof Electrics
- Variable speeds
- Electric Control Panel
- Food and Pharmaceutical Finishes
- Wear Resistance
- Special Inlets and Outlets

Multi-mixers operate on the principle of a mechanically generated fluid bed with 3 dimensional movement. They are perfect for mixing a range of components from fine powder to heavy pastes such as putty and marzipan.

Morton Multi-mixers can be tailor made to suit the customers application and process parameters. These mixers are available in both Batch and Continuous applications.

Multi-Mixer Specification						
Total Capacity		Working Capacity at maximum 50% fill level	Through quantity at 1 min retention	Dimensions in mm (approx)		
Model	Litres	Litres	Approx L/Hr	A	B	C
C150	150	75	4500	1250	550	590
C300	300	150	9000	1500	640	700
C600	600	300	18000	2000	815	835
C1200	1200	600	36000	2500	910	990
C2000	2000	1000	60000	2960	1130	1135
C3000	3000	1500	90000	2960	1270	1310
C4200	4200	1260-2940	126000	3435	1380	1500

Typical Continuous applications include

- Coal Briquettes
- Detergents
- Cement blends
- Animal feeds
- Municipal sludge conditioning
- Muesli bars

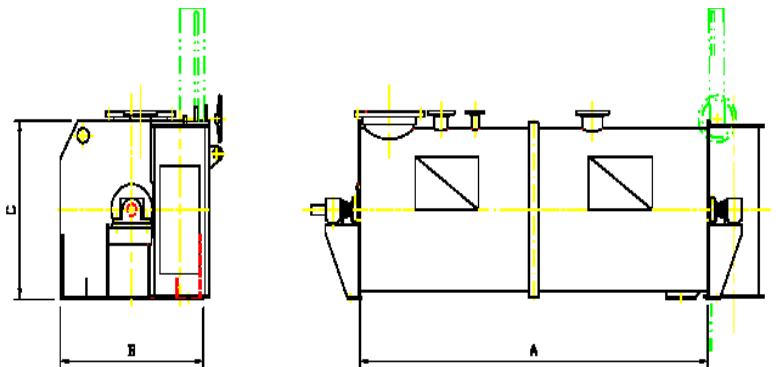

MORTON MIXERS & BLENDERS LIMITED

Grovewood Business Centre, Strathclyde Business Park, Bellshill ML4 3NQ, Scotland U.K.

Tel: +44 (0)845 2770939

Fax: +44 (0)845 2770949

Web: www.morton-mixers.co.uk

Email: info@morton-mixers.co.uk